

CHAINAGE IN (m)	-30	00+000	+30
FORMATION LEVEL (m)	658	658	658
BED LEVEL AT CL (m)	659.578	645.212	658.087

ELEVATION
(SCALE 1:300)

CENTER LINE SHOWN HERE AS 0,
SHOULD BE AT KM. 3+607

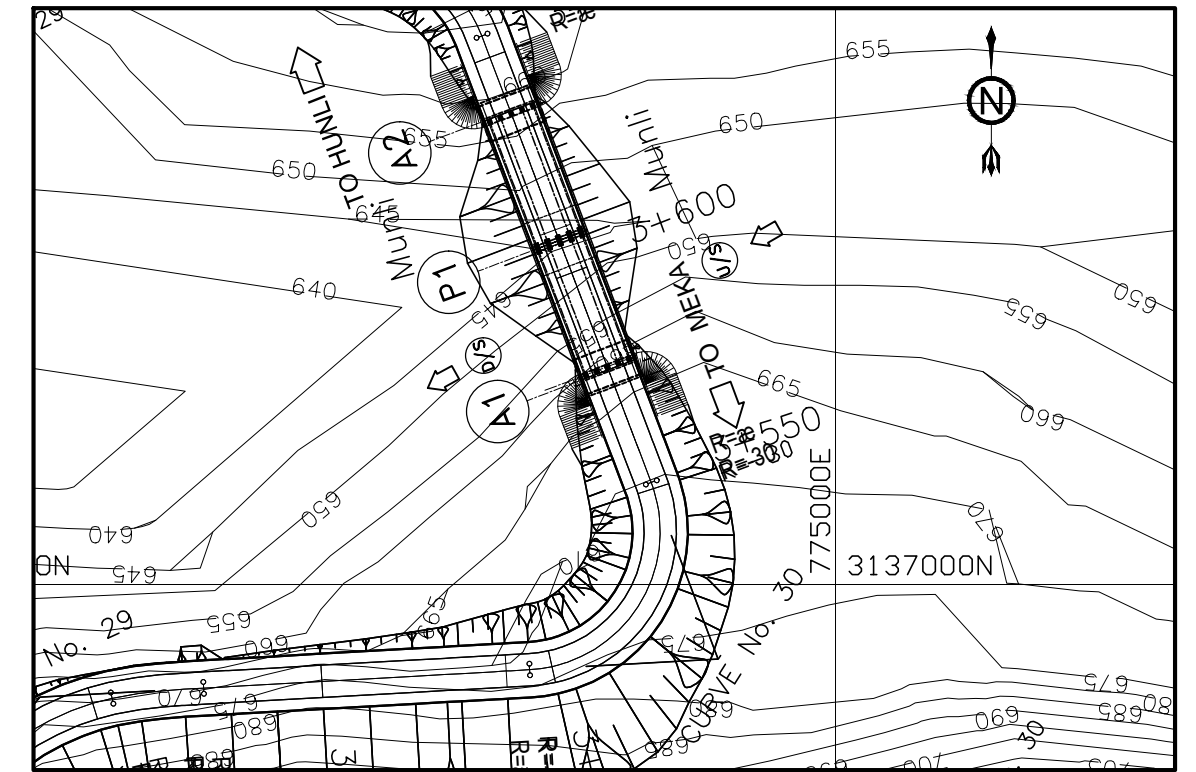

KEY PLAN
(SCALE-1:1500)

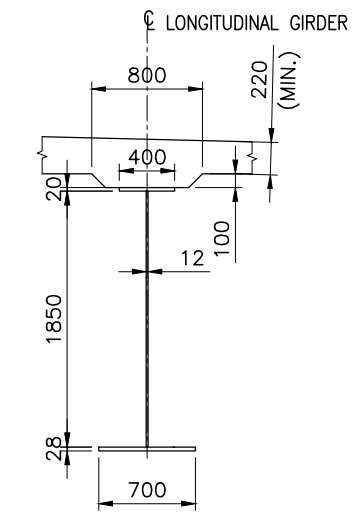
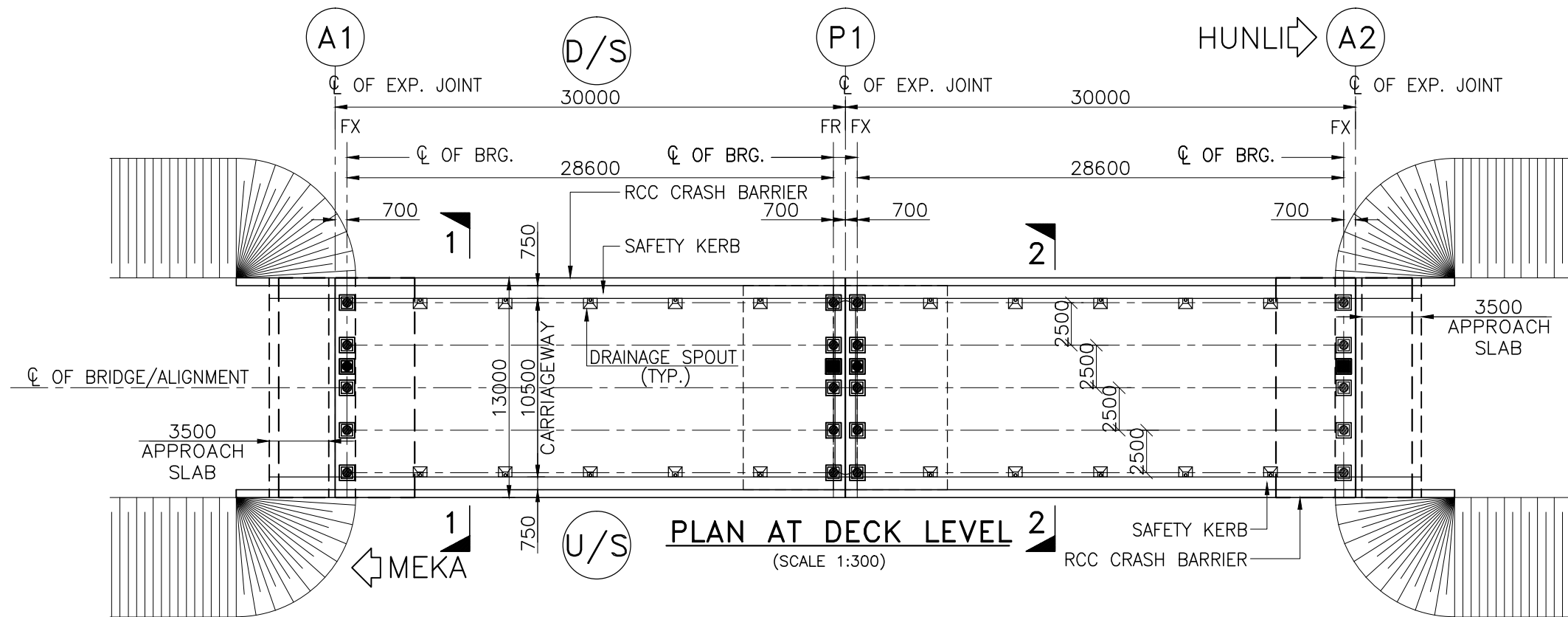

DETAILS OF COMPOSITE GIRDER
(SCALE 1:50)

NOTES :-

- ALL DIMENSIONS ARE IN MILLIMETERS AND LEVELS ARE IN METERS UNLESS NOTED OTHERWISE. DIMENSIONS ARE NOT TO BE SCALED, ONLY WRITTEN DIMENSIONS ARE TO BE FOLLOWED.
- FOR FORMATION LEVELS & SITING OF THE BRIDGE, RELEVANT HIGHWAY PLAN & PROFILE DRAWINGS TO BE REFERRED. IN CASE OF ANY VARIATION HIGHWAY DRAWINGS TO BE CONSIDERED CORRECT.
- THIS DRAWING SHALL BE READ IN CONJUNCTION WITH OTHER RELEVANT DRAWINGS.



BORDER ROADS ORGANISATION



in JV with



Stanley Consultants Inc.

Unit No. 405 A & B, Rectangle I, Saket District Centre
Saket, New Delhi - 110 017

Detailed Project Report for Improvement of
Meka-Roing-Hunli Road to NH Double Lane
Specifications in Dibang District of
Arunachal Pradesh

REV	R0				
DATE	October 2012				
DRAWN					
DESIGNED					
CHECKED					
APPROVED					

Scale:

MEKA-ROING-HUNLI ROAD
FINAL DETAILED PROJECT REPORT
(PACKAGE RH / N2)

Sheet Size:
A2

GENERAL ARRANGEMENT DRAWING OF
MAJOR BRIDGE OVER AIRI NALA
AT KM. 3+607

Drg No: Xplorer-SCI/BRO/11193/FDPR/MJBR/3+607/01 (SH-1 OF 2)